



Woodworking machinery at its best!

**AIR FILTER
OPERATING INSTRUCTIONS**

MODEL: W915



Charnwood, Cedar Court, Walker Road, Bardon Hill, Leicestershire
Tel. 01530 516926 Fax. 01530 516929
email; sales@charnwood.net website; www.charnwood.net

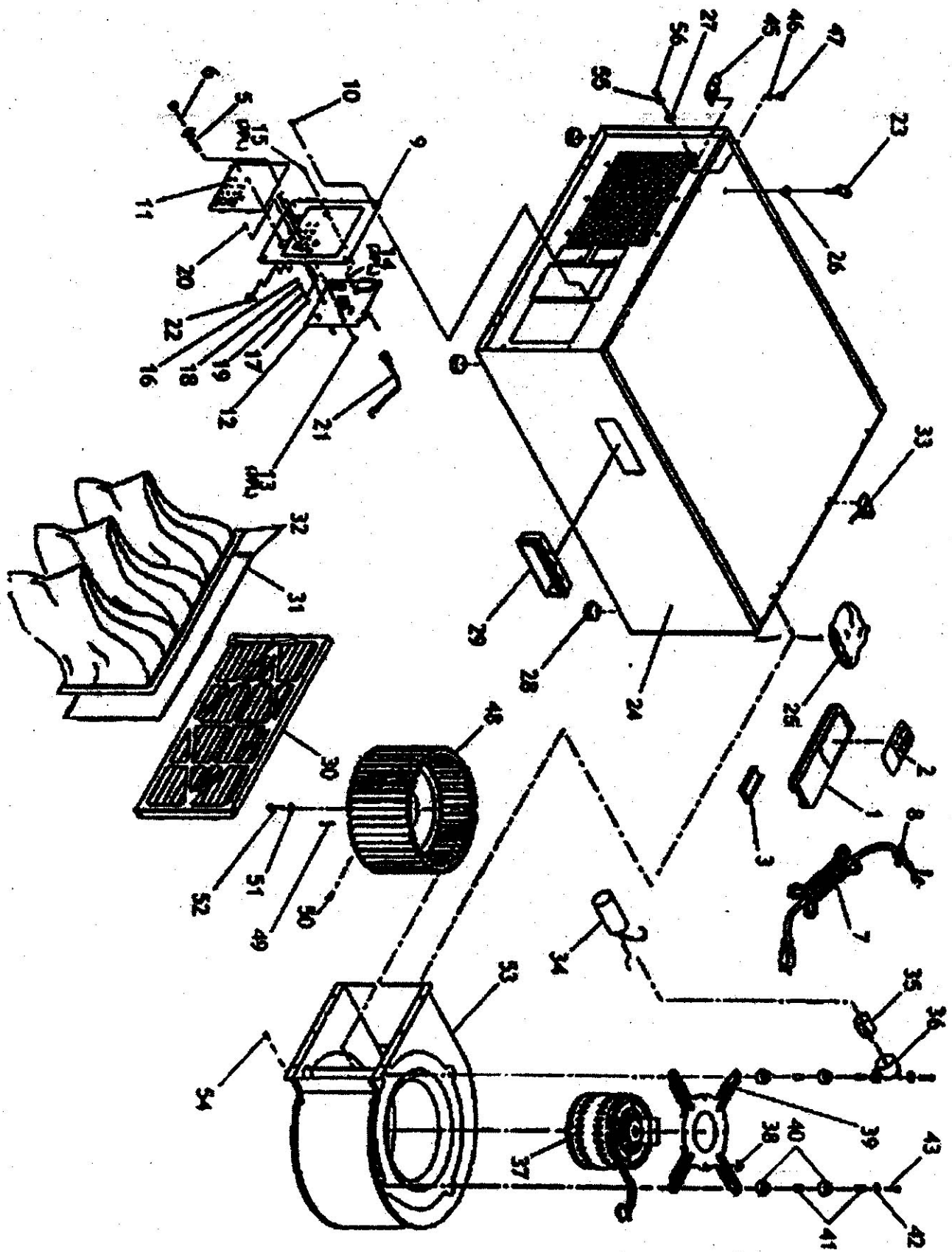

PART	DESCRIPTION	PART	DESCRIPTION
1	REMOTE CONTROL	33	CLIP SET
2	LABEL (CONTROLS)	34	CAPACITOR
3	REMOTE CONTROL COVER	35	INSULATOR
		36	CAPACITOR CLAMP
5	FUSE HOLDER	37	MOTOR
6	1 $\frac{1}{8}$ " FUSE 5-AMP (250VAC)	38	HEX LOCKING NUT M5-0.8
7	POWER CORD 3-WIRE 18-GA	39	FLANGE
8	STRAIN RELIEF	40	SPACER
9	CONTROL PANEL	41	SLEEVE
10	PHLP HD SCR M4-0.7 X 10	42	FLAT WASHER 6MM
11	LABEL (CONTROLS)	43	HEX BOLT M6-1.0 X 30
12	PC BOARD	45	FLANGE BRACKET
13	PHLP HD SCR M3-0.45 X 6.5	46	FLAT WASHER 6MM
14	SPACER (SPECIAL)	47	HEX BOLT M6-1.0 X 10
15	PHLP HD SCR (SPECIAL)	48	FAN
16	EXT TOOTH WSHR 4MM	49	KEY 4 X 4 X 20MM
17	HEX NUT M4-0.75	50	HEX BOLT M8-1.25 X12
18	FLAT WASHER 4MM	51	FLANGE DISK 6.5 X 44MM
19	LOCK WASHER 4MM	52	CAP SCREW M6-1.0 X 20 (LH)
20	PHLP HD SCR M4-0.75 X 6	53	FAN HOUSING
21	PC WIRING HARNESS	54	TAPPING SCREW
22	BOLT (SPECIAL) M3-0.45 X 6.5	55	LOCK WASHER 6MM
23	EYE BOLT M6-1.0 X 20	56	PHLP HD SCR M6-1.0 X 16
24	HOUSING		
25	MOUNT AND BOLT BAG		
26	RIVET NUT M6 X 8		
27	FLAT WASHER 6MM		
28	RUBBER FOOT		
29	HANDLE		
30	PRIMARY FILTER 5-MICRON		
31	FOAM SEAL $\frac{1}{4}$ " X 1" X 70"		
32	SECONDARY FILTER 1-MICRON		